

## DESCRIPTION

Charging power up to 22kW (3 Phase) Compatible with all Type 1 and Type 2 electric cars  
Technical information Connector type: Socket Maximum current: 32 A, 5x10 mm<sup>2</sup> cable DC Leakage protection Included: Yes User interface: myWallbox Portal, Wallbox App Overvoltage Category: CAT III Storage temperature: From -40°C to 70°C RCCB: Requires an external RCCB Nominal frequency: 50 Hz / 60 Hz Degree of protection: IP54 / IK08 Operating temperature From -25 °C to 40 °C Input voltage: 110 / 230 V AC ± 10% (1P) / 400 V AC ± 10% (3P) Included features: Power Sharing Smart Dimensions: 260x192x113 mm Charging power : 22kW Charging mode Mode 3 Charger status information: Wallbox App, myWallbox Portal, RGB LED, Pantalla de 10.9 cm (4.3") Cable length: 5 m Important note If you are a Renault Zoe I (2015 edition) user, please keep in mind that this model is only compatible with this charger for single-phase charging (up to 7.4kW). The Renault Zoe II (2018 edition), ordered after the 19th of March 2018, is perfectly compatible with this charger for both single-phase and three-phase charging (up to 22kW).

Charging cable with connector, 5 meters length, compatible with all electric cars and chargers with Type 2 connector.

- This charging cable is compatible with all electric cars and chargers with Type 2 connector
- Charging power up to 22 kW
- Cable length 5 m
- Charging cable Mode 3
- Single-phase and three-phase AC cable
- Includes covers for connectors

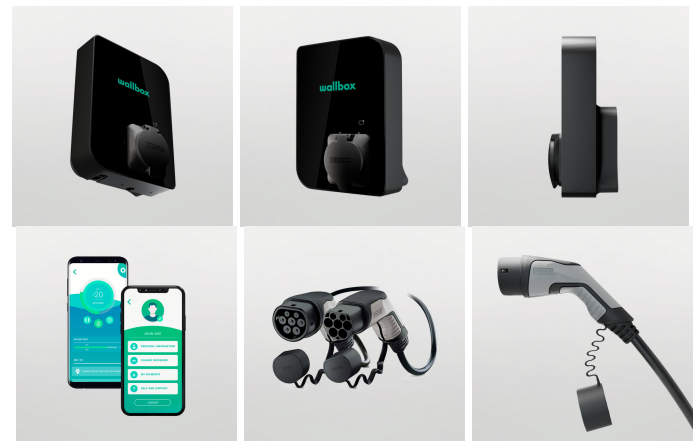

- Compatible with Copper SB, KSIX EVHome+ SC and all public applications with Type 2 socket

## TECHNICAL SPECIFICATIONS.

Color	<b>Black</b>
Degree of protection	<b>IP54</b>
Power	<b>22kW</b>
Connector type	<b>Type 2</b>
Impact resistance	<b>IK08</b>
Power Sharing	<b>Yes</b>
Wireless.	<b>yes</b>
Wifi	<b>Yes</b>
Ethernet	<b>yes</b>
3G/4G	<b>yes</b>
Measures	<b>260 x 192 x 113 mm</b>
OCCP	<b>yes</b>

## STRENGTHS